

# CYLINDRICAL TYPE CAPACITOR DATASHEET

## EKON CYLINDRICAL TYPE CAPACITOR

Ekon Cylindrical tpe Capacitors are high grade metallizde polypropylene from 1-50 kVAr in cylindrical configuration. These capacitors come with a biodegradable soft resin. These capacitors are self-healing type. The capacitors come with an over pressure disconnecter terminals. They can be used to provide effective power factor correction in industrial & semi-industrial applications.



Table1. Capacitor Technical Features

TECHNICAL FEATURES	
Capacitor Type	Cylindrical
Standard	IEC 60831-1 & IEC 60831-2
Rated Reactive Power Voltage	0,25 – 50 kVAr
Rated Voltage	230 – 525 Volts
Rated Frequency	50 / 60 Hz
Maximum Over Voltage (Un Maximum)	Un +%10 (8 Hour in 24 Hours)
	Un +%15 (30 min. in 24 Hours)
	Un +%20 ( 5 min. in 24 Hours)
	Un +%30 ( 1 min. in 24 Hours)
Over Current	Up to 1,3 x I <sub>R</sub>
	(Up to 1,5 x I <sub>R</sub> including combined effect of harmonics, over voltage and capacitance)
Dielectric System	Metallized PolyProPylene Film, Self-Healing
Losses	<0,2 W/kVAr - <0,4 W/kVAr
Protection Class	IP20
Cooling	Natural Air Cooled
Max. Above from sea level	4000 meters
Case	Aluminium Can
Discharge Resistor	Special Design International Discharge Resistance 50V in less than 60 sec.
Terminal	Max. 16mm Cable with Arc Protection Double three day terminal
Execution	Indoor
Inrush Current	Up to 200 x I <sub>R</sub>
Tolerance on Capacitance	-5 % to +10 %
Test Voltage (Terminal to Terminal)	2,15 x V <sub>R</sub> AC for 2 sec.
Test Voltage (Terminal to Casing)	3000 V <sub>AC</sub> for 10 sec.
Temperature Category	-40 °C / +65 °C
Mounting Position	Vertically
Max. Humidity	95 %
Grounding & Mounting	With M8/M12, Protection Type: Over Pressure Sensitive 3 Phase Disconnecter,
	Self- Healing, Dry Type.
Working Life (30°C, %50 Relative Humidity)	180.000 hrs.



Table2. Type1 Capacitors Technical Tables

Product Code	Power (kVAr)	Capacity (µF)	Current (A)	Dxh (mm)	Weight (Kg.)	Packing Unit
<b>U<sub>N</sub>: 231V / 50Hz. U<sub>TR</sub>: 495V AC/2s U<sub>TC</sub>: 3000V AC/10s</b>						
40002	0,25	15,0	1,1	55x100	0,25	30
40005	0,5	30,0	2,2	55x100	0,30	30
40010	1,0	60,0	4,3	55x100	0,35	30
40015	1,5	90,0	6,5	65x100	0,40	20
40020	2,0	120,0	8,7	65x100	0,45	20
40025	2,5	150,0	10,8	65x100	0,50	20
<b>U<sub>N</sub>: 400V / 50Hz. U<sub>TR</sub>: 860V AC/2s U<sub>TC</sub>: 3000V AC/10s</b>						
41005	0,5	3x3,3	0,7	55x100	0,25	30
41010	1,0	3x6,6	1,4	55x100	0,30	30
41015	1,5	3x9,9	2,1	55x100	0,35	30
41025	2,5	3x16,6	3,5	65x100	0,45	20
41050	5,0	3x33,3	7,0	55x200	0,90	20
41075	7,5	3x49,8	10,5	65x200	1,10	20
<b>U<sub>N</sub>: 440V / 50Hz. U<sub>TR</sub>: 946V AC/2s U<sub>TC</sub>: 3000V AC/10s</b>						
42005	0,5	3x2,7	0,65	55x100	0,25	30
42010	1,0	3x5,5	1,30	55x100	0,30	30
42015	1,5	3x8,3	1,96	55x100	0,35	30
42025	2,5	3x13,5	3,30	65x100	0,50	20
42050	5,0	3x27,0	6,60	55x200	0,80	20
42075	7,5	3x40,5	9,90	65x200	1,00	20
<b>U<sub>N</sub>: 480V / 50Hz. U<sub>TR</sub>: 1032V AC/2s U<sub>TC</sub>: 3000V AC/10s</b>						
43005	0,5	3x2,3	0,60	55x100	0,25	30
43010	1,0	3x4,6	1,20	55x100	0,30	30
43015	1,5	3x5,9	1,80	55x100	0,35	30
43025	2,5	3x11,5	3,00	65x100	0,50	20
43050	5,0	3x23,0	6,00	55x200	0,80	20
43075	7,5	3x34,5	9,00	65x200	1,00	20
<b>U<sub>N</sub>: 525V / 50Hz. U<sub>TR</sub>: 1128V AC/2s U<sub>TC</sub>: 3000V AC/10s</b>						
42005	0,5	3x1,9	0,50	55x100	0,25	30
42010	1,0	3x3,8	1,10	55x100	0,30	30
42015	1,5	3x5,7	1,60	55x100	0,35	30
42025	2,5	3x9,6	2,70	65x100	0,50	20
42050	5,0	3x19,6	5,50	55x200	0,80	20
42075	7,5	3x28,9	8,20	65x200	1,00	20

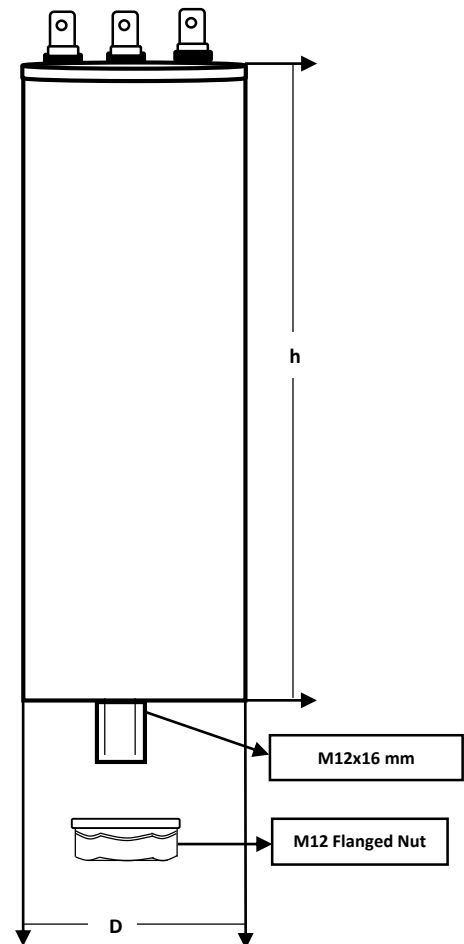
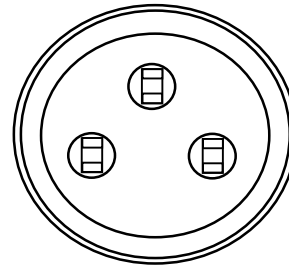

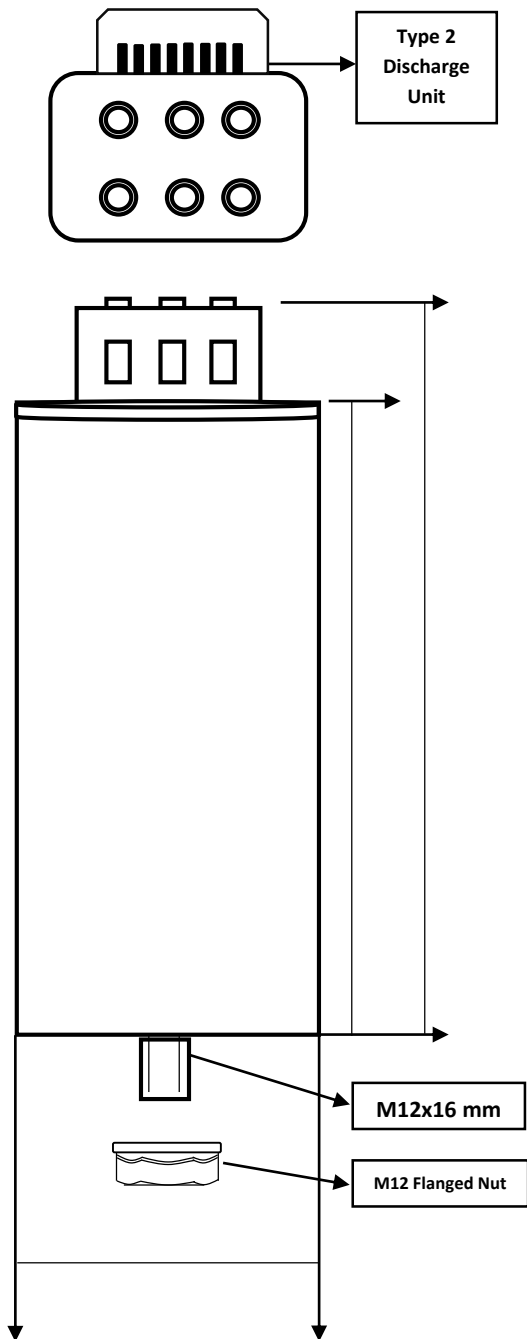

Table3. Type2 Capacitors Technical Tables

Product Code	Power (kVAr)	Capacity (μF)	Current (A)	Dxh (mm)	Weight (Kg.)	Packing Unit
<b>U<sub>N</sub>: 231V / 50Hz.</b>		<b>U<sub>TT</sub>: 495V AC/2s</b>		<b>U<sub>TC</sub>: 3000V AC/10s</b>		
40050	5,0	300,0	21,7	75x210	1,00	12
40075	7,5	450,0	32,6	85x240	1,15	12
40100	10,0	600,0	43,3	100x240	1,25	12
<b>U<sub>N</sub>: 400V / 50Hz.</b>		<b>U<sub>TT</sub>: 860V AC/2s</b>		<b>U<sub>TC</sub>: 3000V AC/10s</b>		
41100	10,0	3x66,6	14,0	75x210	0,95	12
41125	12,5	3x83,0	17,5	85x210	1,10	12
41150	15,0	3x99,9	21,0	85x210	1,28	12
41200	20,0	3x133,3	28,0	100x240	1,78	12
41250	25,0	3x166,6	35,0	100x240	1,95	12
41300	30,0	3x199,9	42,0	116x240	2,70	6
<b>U<sub>N</sub>: 440V / 50Hz.</b>		<b>U<sub>TT</sub>: 946V AC/2s</b>		<b>U<sub>TC</sub>: 3000V AC/10s</b>		
42100	10,0	3x54,0	13,5	75x210	0,91	12
42125	12,5	3x67,5	16,5	85x210	1,08	12
42150	15,0	3x83,0	19,8	85x210	1,25	12
42200	20,0	3x108,0	26,5	100x240	1,75	12
42250	25,0	3x135,0	33,0	100x240	1,91	12
42300	30,0	3x162,0	39,6	116x240	2,66	6
<b>U<sub>N</sub>: 480V / 50Hz.</b>		<b>U<sub>TT</sub>: 1032V AC/2s</b>		<b>U<sub>TC</sub>: 3000V AC/10s</b>		
43100	10,0	3x46,1	12,0	75x210	1,10	12
43125	12,5	3x57,5	15,0	85x240	1,25	12
43150	15,0	3x69,1	18,0	85x240	1,50	12
43200	20,0	3x92,1	24,0	100x240	2,05	12
43250	25,0	3x115,1	30,0	100x240	2,15	12
43300	30,0	3x138,5	36,0	116x240	2,63	6
<b>U<sub>N</sub>: 525V / 50Hz.</b>		<b>U<sub>TT</sub>: 1128V AC/2s</b>		<b>U<sub>TC</sub>: 3000V AC/10s</b>		
42600	10,0	3x38,5	11,0	75x210	1,00	12
42625	12,5	3x48,5	13,7	85x240	1,20	12
42650	15,0	3x57,5	16,5	85x240	1,45	12
42700	20,0	3x77,0	22,0	100x240	2,00	12
42750	25,0	3x96,0	27,5	100x240	2,10	12
42800	30,0	3x115,5	33,0	116x240	2,58	6

Table4. Type3 Capacitors Technical Tables

Product Code	Power (kVAr)	Capacity (µF)	Current (A)	Dxh (mm)	Weight (Kg.)	Packing Unit
<b>U<sub>N</sub>: 400V / 50Hz.                      U<sub>TT</sub>: 860V AC/2s                      U<sub>TC</sub>: 3000V AC/10s</b>						
41400	40,0	3x265,5	58,0	136x290	4,95	4
41500	50,0	3x331,5	72,1	136x290	5,15	4
<b>U<sub>N</sub>: 440V / 50Hz.                      U<sub>TT</sub>: 946V AC/2s                      U<sub>TC</sub>: 3000V AC/10s</b>						
42400	40,0	3x219,5	52,5	136x290	4,80	4
42500	50,0	3x274,5	65,5	136x290	5,00	4
<b>U<sub>N</sub>: 480V / 50Hz.                      U<sub>TT</sub>: 1032V AC/2s                      U<sub>TC</sub>: 3000V AC/10s</b>						
43400	40,0	3x184,5	48,2	136x290	4,70	4
43500	50,0	3x230,5	60,5	136x290	4,95	4
<b>U<sub>N</sub>: 525V / 50Hz.                      U<sub>TT</sub>: 1128V AC/2s                      U<sub>TC</sub>: 3000V AC/10s</b>						
42900	40,0	3x154,0	44,0	136x290	4,65	4
43000	50,0	3x192,5	53,0	136x290	4,90	4
<b>U<sub>N</sub>: 690V / 50Hz.                      U<sub>TT</sub>: 1438V AC/2s                      U<sub>TC</sub>: 3000V AC/10s</b>						
47640	40,0	3x89,5	33,5	136x290	4,50	4
47650	50,0	3x111,5	42,0	136x290	4,75	4

